

SURVEY CONTROL DATA

1. HORIZONTAL CONTROL:

A. HORIZONTAL CONTROL FOR THIS SURVEY IS THE OKLAHOMA DEPARTMENT OF TRANSPORTATION PLANE COORDINATE SYSTEM, LAMBERT PROJECTION (NORTH ZONE), ALL COORDINATES SHOWN ARE OKLAHOMA DEPARTMENT OF TRANSPORTATION PLANE COORDINATES NAD 83(93) WHICH WERE DERIVED BY MULTIPLYING THE NGS OKLAHOMA PLANE COORDINATES BY THE COMBINED ADJUSTMENT FACTOR OF 1.00010. THE OKLAHOMA DEPARTMENT OF TRANSPORTATION COORDINATE SYSTEM PLANE IS 2350 FEET ABOVE THE OKLAHOMA NGS STATE PLANE.

B. ACCURACY - THE PRIMARY CONTROL NETWORK, THE SECONDARY CONTROL NETWORK AND THE SECTION BOUNDARIES FOR THIS SURVEY ARE IN GENERAL COMPLIANCE WITH NGS SECOND ORDER, CLASS II STANDARDS FOR HORIZONTAL CONTROL (1:20,000).

2. BEARINGS:

THE BEARINGS SHOWN HEREIN OR HEREON ARE GRID BEARINGS DERIVED FROM THE NGS OKLAHOMA STATE PLANE COORDINATE SYSTEM AND ARE NOT ASTRONOMICAL. THE ANGLE OF VARIANCE BETWEEN GRID NORTH (GN) AND THE ASTRONOMICAL TRUE NORTH (TN) IS DEPICTED DIAGRAMMATICALLY.

3. VERTICAL CONTROLS:

A. LEVEL DATUM IS MEAN SEA LEVEL NAVD 88.

B. ACCURACY - VERTICAL CONTROL FOR THIS SURVEY IS WITH THE CLOSURE REQUIREMENTS OF NGS THIRD ORDER STANDARDS AS A MINIMUM.

STATE OF OKLAHOMA  
DEPARTMENT OF TRANSPORTATION

SURVEY OF  
STATE HIGHWAY 74  
SWO 3868(1)  
STATE JOB NO. 08095(04)  
OKLAHOMA COUNTY  
PROJECT LOCATION

INDEX OF SHEETS

1. TITLE SHEET
2. SURVEY INFORMATION (surveyor's certification, & cogo points)
- 3-4. SURVEY INFORMATION (alignment)
- 5-27. SURVEY DATA SHEETS
- 28-41. LAND TIE DATA SHEETS

SURVEY BEGAN: NOVEMBER 1997  
SURVEY COMPLETED: NOVEMBER 1999

GREG GUNNING, PLS  
BILLY MUSICK, TRANS. SPEC. LEVEL II  
JAMES WALSH, TRANS. SPEC. LEVEL I  
ROSS GOERINGER, TRANS. SPEC. LEVEL I  
JEFF MORRISON, TRANS. TECH. LEVEL I

EQUIPMENT:  
TOPCON TURBO SII GPS EQUIPMENT 165-U, 259-U, 853-U, 871-U  
TOPCON DL-102 DIGITAL LEVEL GM1304  
TOPCON GTS-3D TOTAL STATION

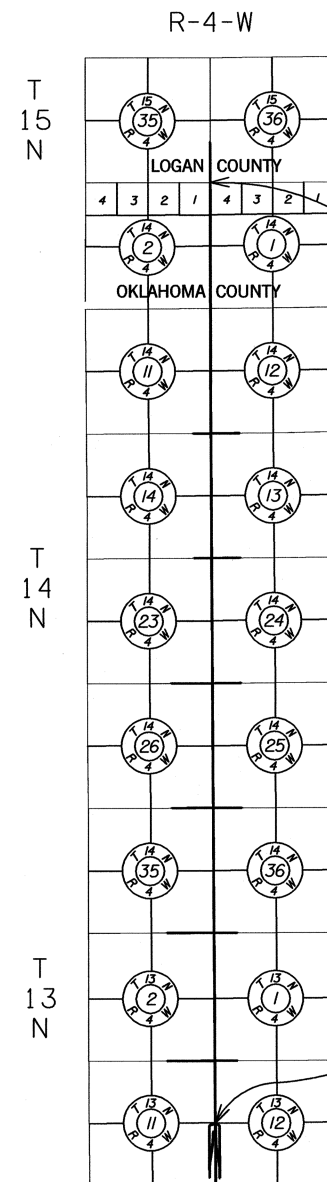

PROJECT EXTENTS



SCALES  
SURVEY DATA SHEETS 1" = 100'  
LAND TIE DATA SHEETS 1" = 500'

CONVENTIONAL SYMBOLS

- PROPOSED ROAD
- RAILROADS
- RANGE & TOWNSHIP
- SECTION LINES
- QUARTER SECTION LINES
- FENCES
- GROUND LINE
- EXISTING ROADS
- BASE LINE
- GRADE LINES
- TELEPHONE & TELEGRAPH
- POWER LINES
- BUILDINGS
- OILWELL
- DRAINAGE STRUCTURES - IN PLACE
- DRAINAGE STRUCTURES - NEW
- RIGHT-OF-WAY LINES - EXISTING
- RIGHT-OF-WAY LINES - NEW
- CONTROLLED ACCESS
- RIGHT-OF-WAY FENCE

THIS SURVEY MEETS THE OKLAHOMA MINIMUM STANDARDS FOR THE PRACTICE OF LAND SURVEYING AS ADOPTED BY THE OKLAHOMA STATE BOARD OF REGISTRATION FOR PROFESSIONAL ENGINEERS AND LAND SURVEYORS, JULY 11, 2003.

MAIN SURVEY LINE  
PROJECT LENGTH 39809.20 Ft. 7.54 MI.

EQUATIONS : NONE  
EXCEPTIONS : NONE

SPECIFICATIONS FOR SURVEYS FOR PRIMARY AND SECONDARY HIGHWAYS DATED SEPTEMBER 11, 2001 GOVERN.

HAROLD GUNNING SURVEYING

1108 EAST MAIN C.A. NO. 2248  
CORDELL, OKLAHOMA 73632  
EXPIRATION DATE: 6-30-2005

PLS	GHG	OKLAHOMA DEPARTMENT OF TRANSPORTATION SURVEY DIVISION
DRAWN	TRK	
CHECKED		
APPROVED		
CREW GUNNING		SURVEY DATA SHEET SHEET 1 OF 43

SWO 3868 (1) PROJECT NO. 14964(08) SHEET NO. S1